



66 Coast Drive, Greatstone

£360,000 Freehold

Three Bedroom • Low Maintenance Garden • Detached Bungalow • Close to Beach • Large Living Room • Kitchen/Diner • Conservatory • Walking Distance to Sandy Beach





Ground Floor

Approx. 94.4 sq. metres (1015.6 sq. feet)

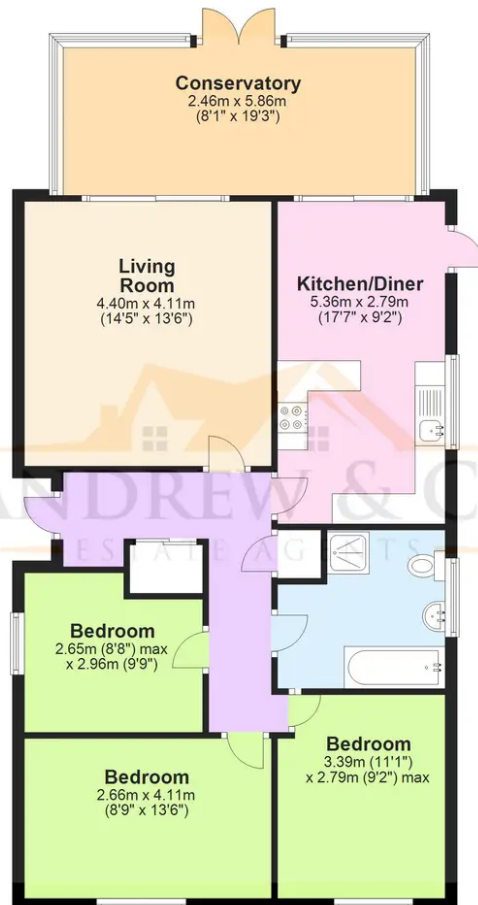

Total area: approx. 94.4 sq. metres (1015.6 sq. feet)

Plans are for layout purposes only and not drawn to scale, with any doors, windows and other internal features merely intended as a guide.
Plan produced using PlanUp.