



## Running waters, Old Romney, Romney Marsh

£125,000 Leasehold

New Build • Holiday Lodge • Private Family Owned Park • Two Bedroom • En-Suite to Master Bedroom • Open Plan Living • Fully Furnished • Terrace





**Ground Floor**

Approx. 66.1 sq. metres (711.9 sq. feet)

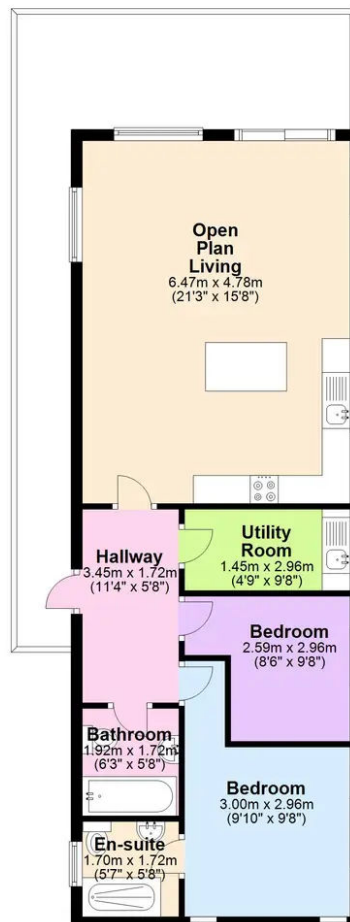

Total area: approx. 66.1 sq. metres (711.9 sq. feet)

Plans are for layout purposes only and not drawn to scale, with any doors, windows and other internal features merely intended as a guide.  
Plan produced using PlanUp.