



66 Elm Road, St. Marys Bay

£270,000 Freehold

Two Bedroom Bungalow • Semi Detached • Generous Living Space • In Need of Some Updating • Chain Free





Ground Floor

Approx. 72.5 sq. metres (780.4 sq. feet)

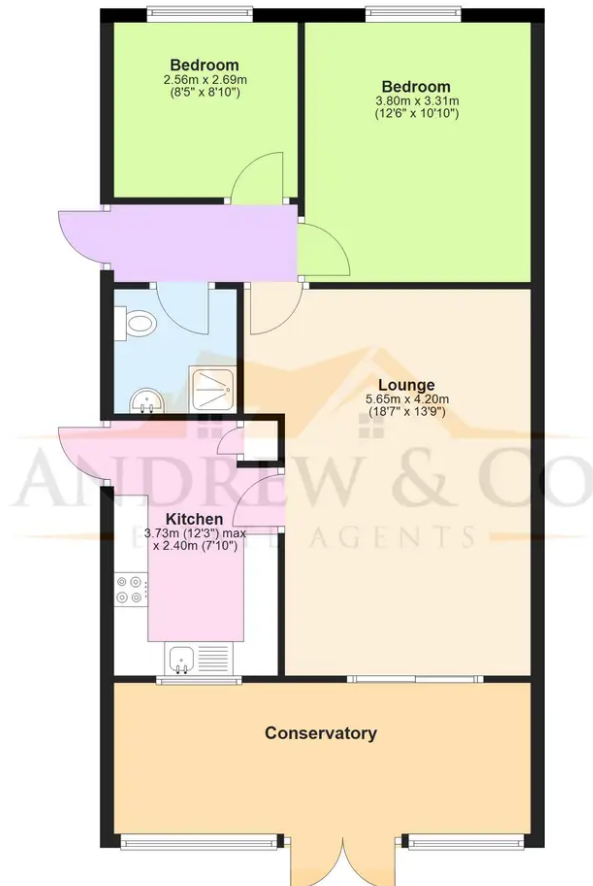

Total area: approx. 72.5 sq. metres (780.4 sq. feet)

Plans are for layout purposes only and not drawn to scale, with any doors, windows and other internal features merely intended as a guide.
Plan produced using PlanUp.