



Mill Road, Lydd

Romney Marsh

£360,000

31 Mill Road

Lydd, Romney Marsh

Beautiful three bed bungalow in popular location. Extended to offer modern kitchen/diner, spacious living room, and master suite with walk-in wardrobe. Private rear garden with off-street parking and garage. Close to local amenities. Comfortable and practical living space.

- Three Bedroom
- Detached Bungalow
- Extended to the Rear
- Three Double Bedroom
- Walk in Wardrobe to Master
- Kitchen/Diner
- Private Rear Garden
- Off Street Parking





Entrance Hall

Living Room

15' 1" x 11' 3" (4.60m x 3.43m)

Breakfast/Dining Room

20' 0" x 8' 11" (6.10m x 2.72m)

Utility Room

Bedroom

11' 11" x 11' 6" (3.63m x 3.51m)

Walk in Wardrobe

Bedroom

12' 1" x 11' 0" (3.69m x 3.36m)

Bedroom

11' 5" x 10' 1" (3.48m x 3.08m)

Bathroom

WC





Ground Floor

Approx. 99.2 sq. metres (1068.2 sq. feet)

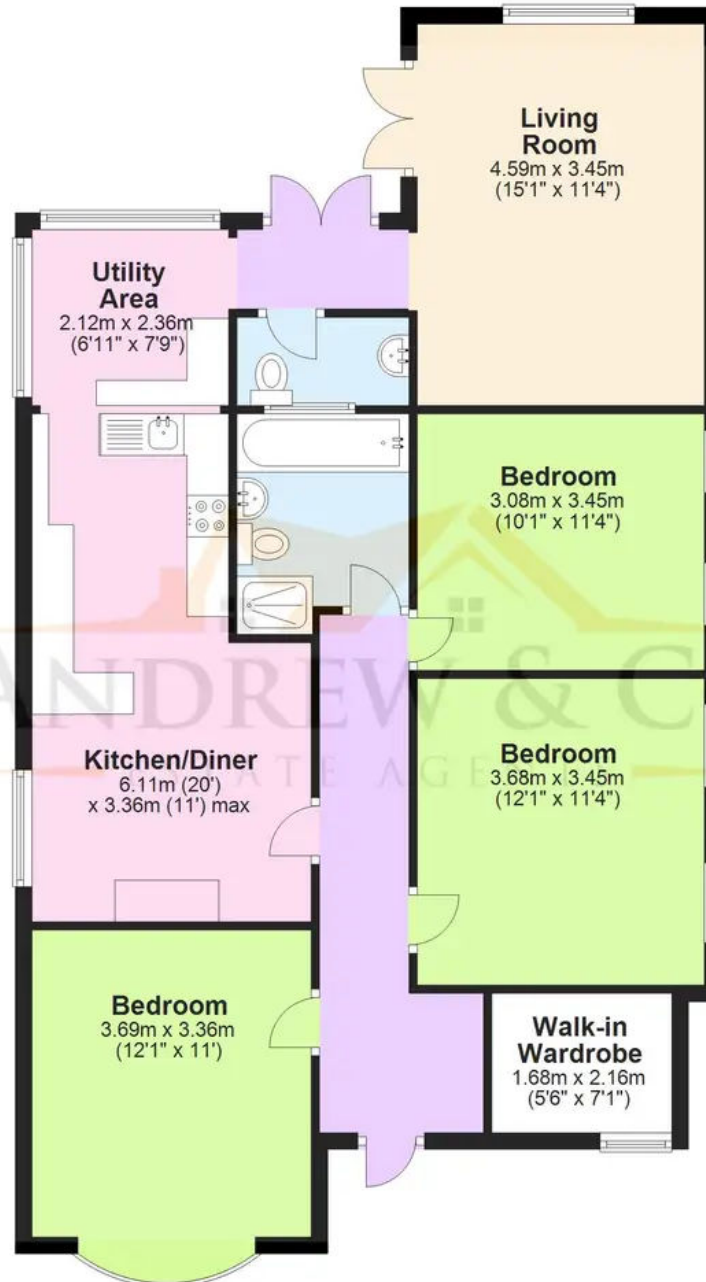

Total area: approx. 99.2 sq. metres (1068.2 sq. feet)

Plans are for layout purposes only and not drawn to scale, with any doors, windows and other internal features merely intended as a guide.
Plan produced using PlanUp.

These particulars are intended to give a fair and reliable description of the property but no responsibility for any inaccuracy or error can be accepted and do not constitute an offer or contract. We have not tested any services or appliances (including central heating if fitted) referred to in these particulars and purchasers are advised to satisfy themselves as to the working order and condition, if a property is unoccupied at any time there may be reconnection charges for any switched off/disconnected or drained services or appliances. All measurements are approximate.



Andrew & Co Estate Agents - New Romney

01797 362898

newromney@andrewandco.co.uk

