



14 Johannesburg Road, D

Guide Price £260,000 - £280,000





14 Johannesburg Road

Dover, Dover

Charming 2-bed semi-detached house for sale without chains, priced £260-280k. Recently refurbished with delightful valley view. EPC "C", spacious workshop, large driveway. Ideal for starter home, downsizing, or peaceful retreat. Council Tax band: B

Tenure: Freehold

- Guide Price £260,000 - £280,000
- Semi Detached Property
- Two Bedrooms
- Chain Free Sale
- Newly Refurbished Throughout
- Lovely View's Over the Valley
- Large Workshop / Shed
- EPC Rating "C"

Entrance Hall

5' 8" x 6' 2" (1.72m x 1.89m)

UPVC glazed front door and UPVC double glazed window to the front of the property also, newly laid carpeted floor coverings with stairs to first floor landing. Three storage cupboards with a radiator and coving. Doors to:-

Lounge

12' 3" x 13' 8" (3.73m x 4.17m)

UPVC double glazed patio door with windows either side of the doors, newly laid carpeted floor coverings with coving and a radiator.

Kitchen / Diner

17' 0" x 10' 8" (5.18m x 3.24m)

UPVC double glazed window to the front of the property with fitted blind then UPVC double glazed patio doors out to the garden also with fitted blinds inside the frame of the door. Matching wall and base units with gas five ring hob, extractor fan and fan oven. Space for a fridge / freezer and a washing machine. Tiled flooring and a radiator. Also a good size pantry cupboard.

Landing

17' 10" x 5' 7" (5.43m x 1.70m)

UPVC double glaze window to the front of the property with newly laid carpeted floor coverings, loft hatch, airing cupboard/boiler cupboard, coving and a radiator. Doors to:-

Bedroom

12' 3" x 11' 1" (3.74m x 3.39m)

UPVC double glazed window to the rear of the property with lovely views over Dover and the valley behind, newly laid carpeted floor coverings, built in wardrobe and a radiator.

Bedroom

10' 11" x 10' 7" (3.33m x 3.23m)

UPVC double glazed window to the rear and side of the property with lovely views over Dover and the valley behind, newly laid carpeted floor coverings, built in wardrobe and a radiator.



Ground Floor

Approx. 58.0 sq. metres (624.0 sq. feet)

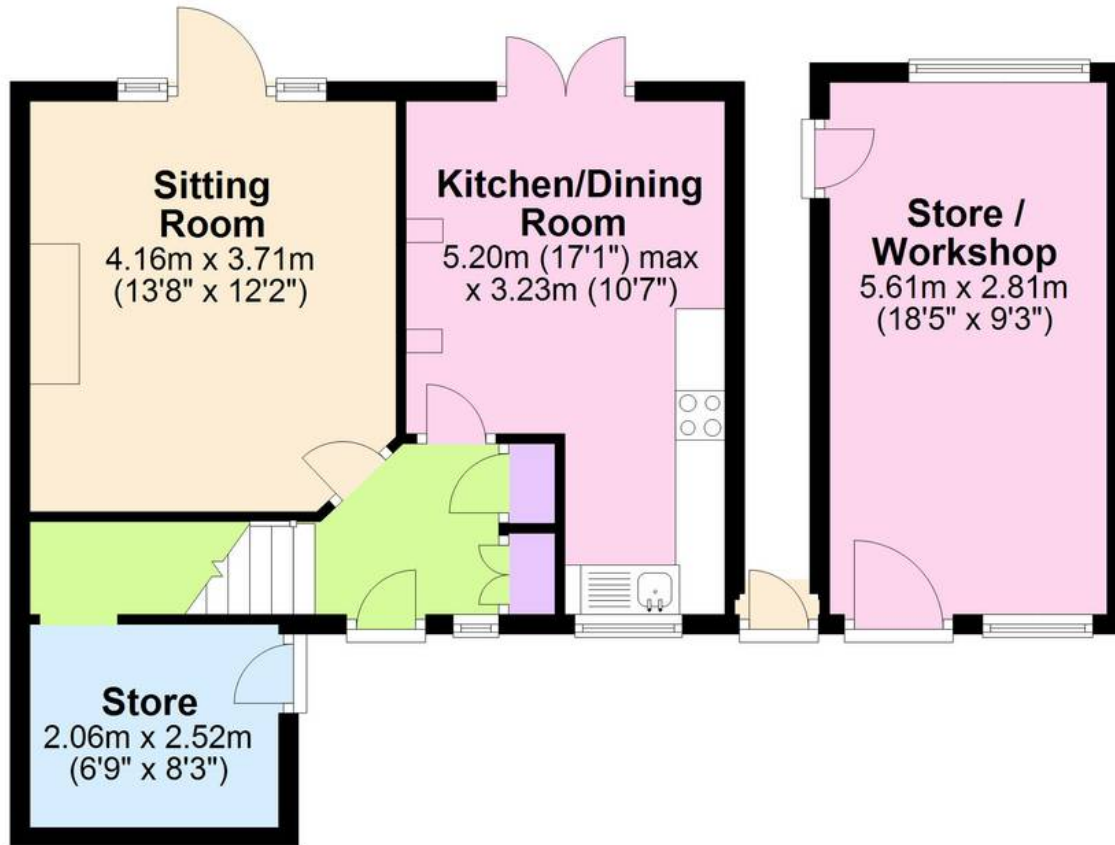

First Floor

Approx. 36.6 sq. metres (394.0 sq. feet)



Total area: approx. 94.6 sq. metres (1018.1 sq. feet)

Disclaimer: These plans are for information purposes only and are intended to show approximate measurements only. No responsibility is taken for error or omission. Kent Energy Company.

Plan produced using PlanUp.