



108 High Street, Lydd

£200,000 Freehold

Two Bedroom • End of Terrace Cottage • Two Reception Rooms • Generous Rear Garden • Chain Free •
Upstairs Bathroom • Close to Local Shops





Ground Floor

Approx. 35.2 sq. metres (378.7 sq. feet)



First Floor

Approx. 30.6 sq. metres (329.9 sq. feet)

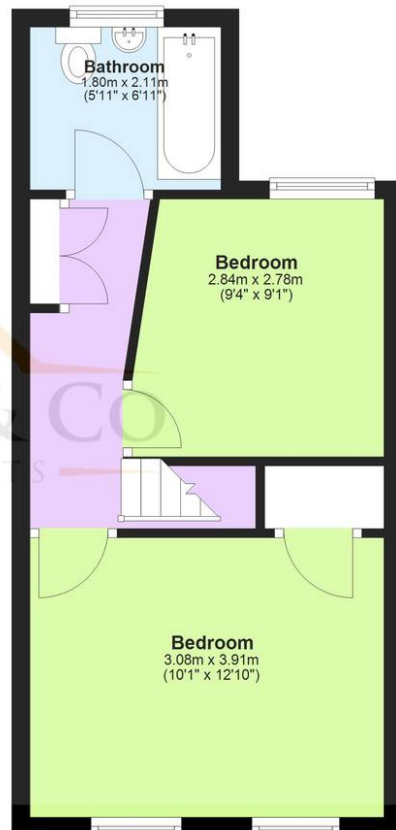

Total area: approx. 65.8 sq. metres (708.6 sq. feet)

ANDREW & CO
ESTATE AGENTS