



**32 School Road, Hothfield**

Offers Over **£260,000**

## 32 School Road

Hothfield, Ashford

A three-bedroom end of terrace home, located in the village of Hothfield, available for sale with no onward chain.

Council Tax band: C

Tenure: Freehold

- Three-bedroom terraced house
- Gas central heating
- Generous rear garden
- On-road parking available
- Children's play park opposite
- Hothfield village location
- No onward chain



### Hallway

uPVC door to the front, stairs to first floor, radiator, fitted carpet.

### Lounge

Dual aspect with windows to the front and rear, feature fireplace, TV points, radiator, fitted carpet.

### Kitchen/Diner

Comprising matching wall and base units with worksurfaces over, inset stainless steel sink/drain, free-standing electric cooker with extractor above, built-in dishwasher, space for free-standing fridge/freezer. Tiled splash back and tiled flooring. Under-stairs storage cupboard and pantry cupboard with space and plumbing for a washing machine. Dual aspect with windows to the front and rear and door to the garden.

### Landing

Loft access, window to the rear, airing cupboard, carpet fitted to the stairs and landing.

### Bedroom 1

Window to the front, built-in cupboard, radiator, fitted carpet.

### Bedroom 2

Window to the front, built-in cupboard, radiator, fitted carpet.

### Bedroom 3

Window to the rear, built-in cupboard, radiator, fitted carpet.

### Bathroom

Comprising a bath with mixer taps and shower over, wash basin, radiator, partly tiled walls, tiled floor. Window to the rear.

### WC

Window to the rear, WC, wash basin, radiator.



## REAR GARDEN

Lawned garden with fenced boundaries.



Ground Floor

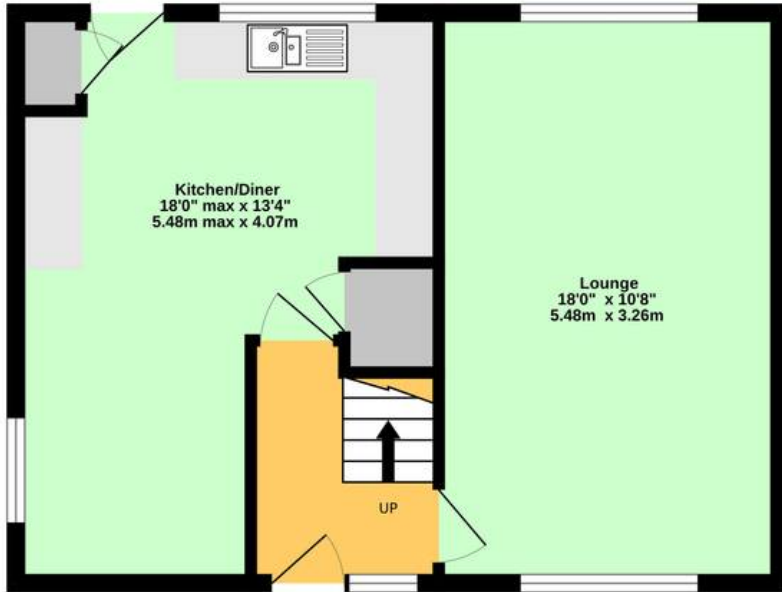

1st Floor

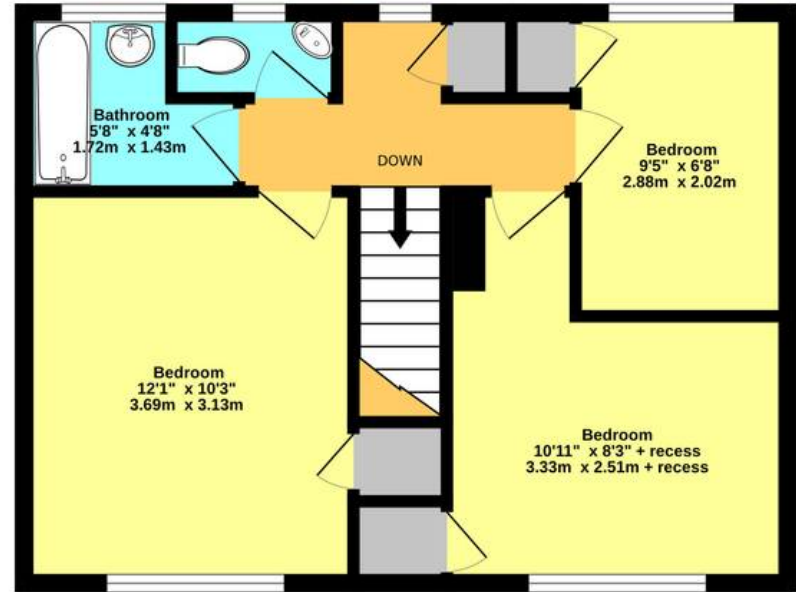

Whilst every attempt has been made to ensure the accuracy of the floorplan contained here, measurements of doors, windows, rooms and any other items are approximate and no responsibility is taken for any error, omission or mis-statement. This plan is for illustrative purposes only and should be used as such by any prospective purchaser. The services, systems and appliances shown have not been tested and no guarantee as to their operability or efficiency can be given.  
Made with Metropix ©2024

These particulars are intended to give a fair and reliable description of the property but no responsibility for any inaccuracy or error can be accepted and do not constitute an offer or contract. We have not tested any services or appliances (including central heating if fitted) referred to in these particulars and purchasers are advised to satisfy themselves as to the working order and condition, if a property is unoccupied at any time there may be reconnection charges for any switched off/disconnected or drained services or appliances. All measurements are approximate.

**Andrew & Co Estate Agents - Ashford**

01233 632383

[info@andrewandco.co.uk](mailto:info@andrewandco.co.uk)

