



5 Cheviot Way, Ashford

Ashford

Offers in Region of **£185,000**



Well-located second-floor apartment in sought-after Quantock Drive area. Ideal for first-time buyers or investors. Features spacious living area, well-appointed kitchen, two generously sized bedrooms. Garage en-bloc, local amenities, green spaces nearby. Don't miss out - call to view now!

Council Tax band: A

Tenure: Leasehold

EPC Energy Efficiency Rating: E

EPC Environmental Impact Rating: F

- NO ONWARD CHAIN
- Second Floor Apartment
- Garage en-bloc
- 2 Bedrooms
- Popular Quantock Drive Location
- Ideal first time buy or buy to let investment property
- Balance of 125 Year Lease from March 2023

Hallway

Lounge/Diner

17' 0" x 10' 4" (5.18m x 3.15m)

With window to front.

Kitchen

With range of cupboards and drawers beneath work surfaces, wall mounted units. Sink with mixer tap and drainer.

Bedroom

11' 4" x 11' 11" (3.45m x 3.63m)

Carpeted with window to rear, built in wardrobe.

Bedroom

12' 2" x 9' 3" (3.71m x 2.82m)

Carpeted with window to rear, built in wardrobe.

Bathroom

White suite comprising low level wc, pedestal wash hand basin, panelled bath, obscured window to front.





Ground Floor

Approx. 57.6 sq. metres (619.9 sq. feet)

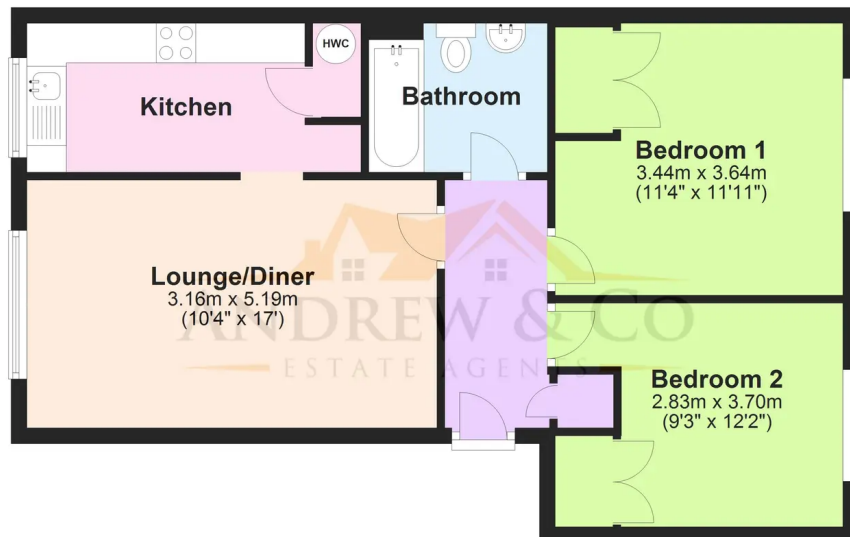

Total area: approx. 57.6 sq. metres (619.9 sq. feet)

Plans are for layout purposes only and are not drawn to scale, with any doors, windows and other internal features merely intended as a guide.
Plan produced using PlanUp.



Ground Floor

Approx. 57.6 sq. metres (619.9 sq. feet)

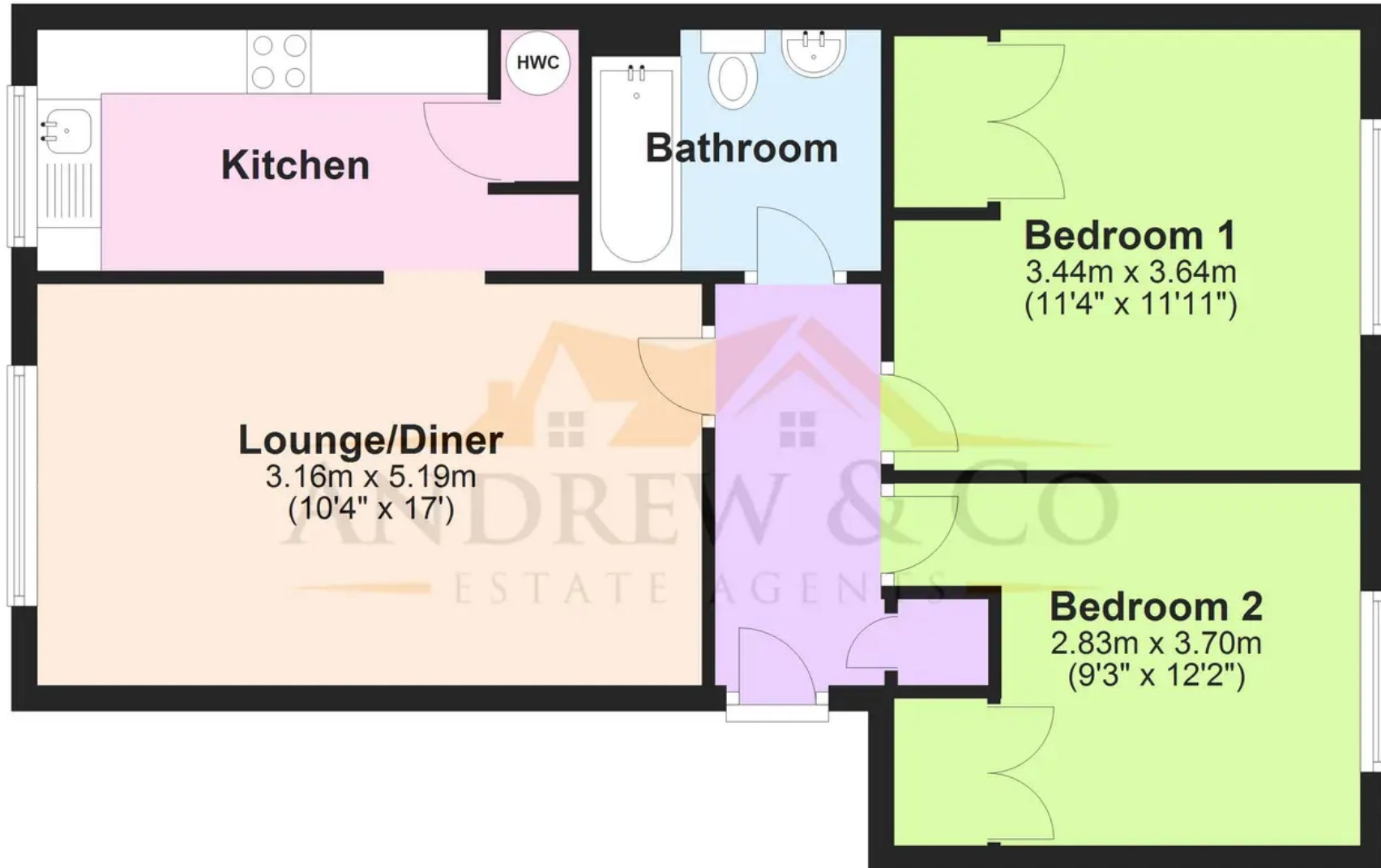

Total area: approx. 57.6 sq. metres (619.9 sq. feet)

Plans are for layout purposes only and are not drawn to scale, with any doors, windows and other internal features merely intended as a guide.

Plan produced using PlanUp.

You can include any text here. The text can be modified upon generating your brochure.